

K-2.80

hall

tampon

6

$51 - (2.10 + 2.16) = 46.74$

$59 - (4 + 2.10) = 52.9$

$19.68 \times 3 = 59$

$18.23 - (1.20 + 1.1) = 15.93$

$2.8 + 18.60 = 21.40$

$18.60 \times 5 = 93.00$

$24 - (2.10 + 8) = 13.9$

$24.3 = 1.2 - 10 = 6.3$

$24 \times 12 = 288$

$16.2 \times 22.8 = 369.36$

$16 \times 12 = 192$

30 pers.

Plansa 1
Plan Corp A, cota ±0,00

Sy interior
1/1000

Plansa 1-Plan Corp A, cota ±0,00

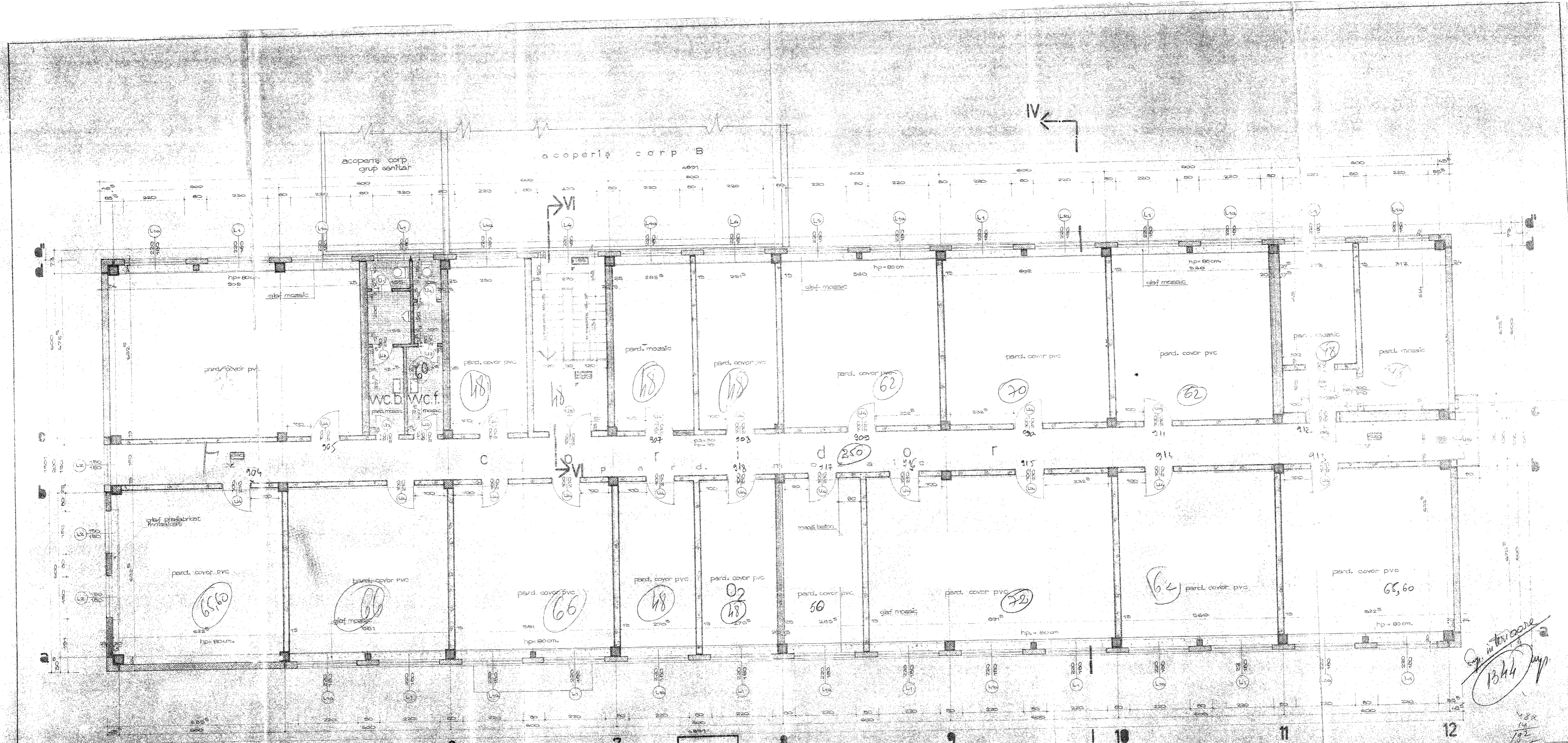

acoperiș corp grup sanitar

acoperiș corp B

WC.B/W.C.F.

Schema ansamblu

- Legendă
- zidărie cărămidă
 - zidărie beton beton autoclădit
 - beton armat monolit
 - balaș armat prefabricat sau pretunat

De acord:

- partea constructivă: ing. Iordache
- partea AMC: ing. Grosu
- partea rezistență: ing. Dăbulețu I.

Planșă 2 - Plan Corp A, cota +3.60

Planșă 2
Plan Corp A, cota +3.60

Ștefan Iordache
1344

153

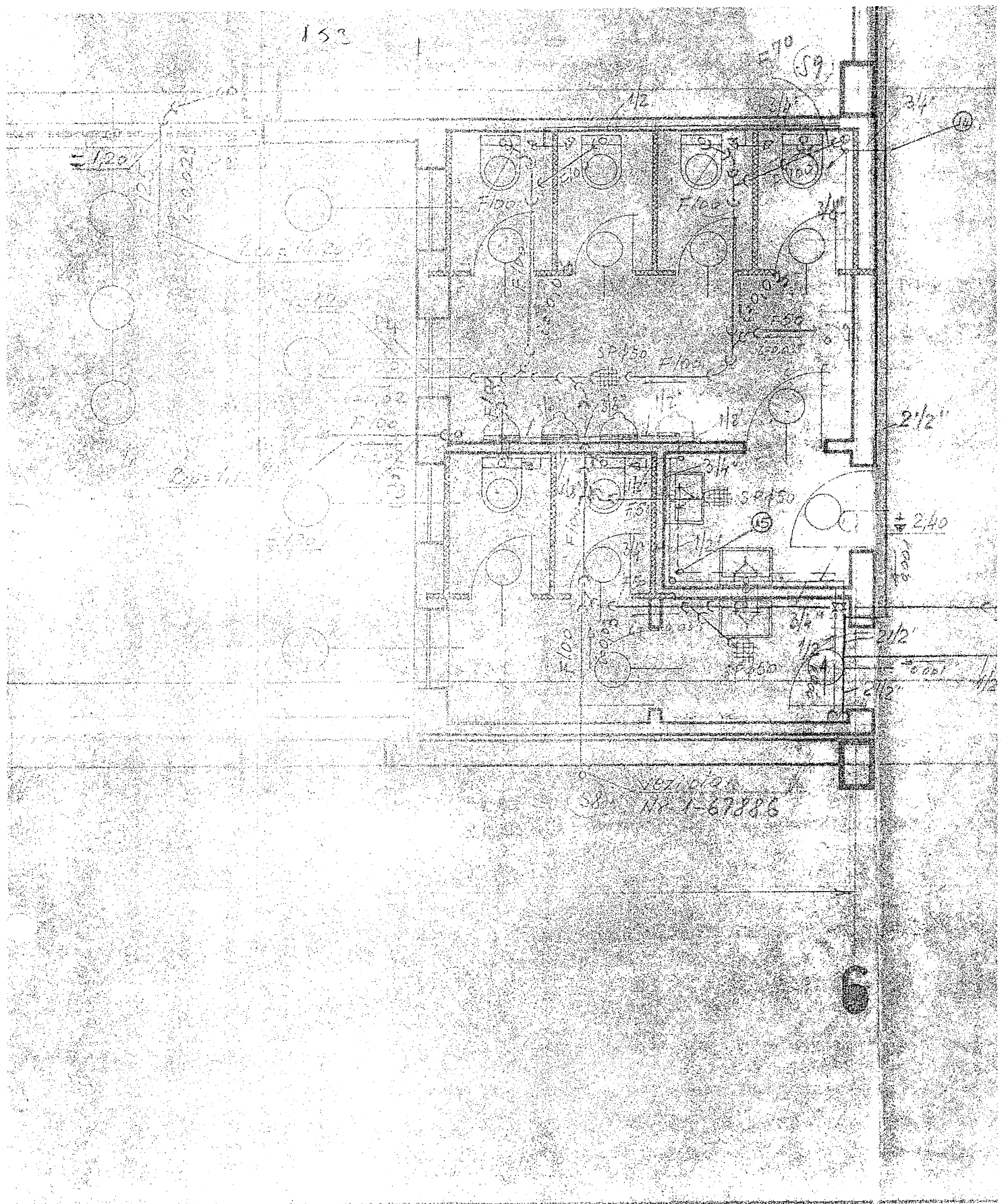

167.0106
Nr 1-67886

Planşa 3 - Plan grupuri sanitare